

# Wall mount Instructions For UCS A-Wing – (75275)

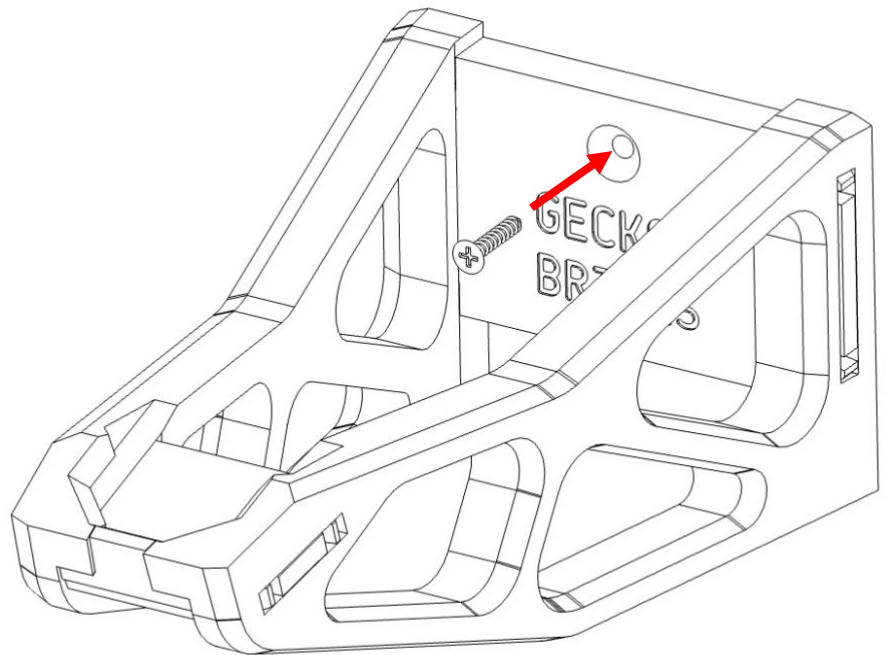

## Wall mount Instructions For UCS A-Wing – (75275)

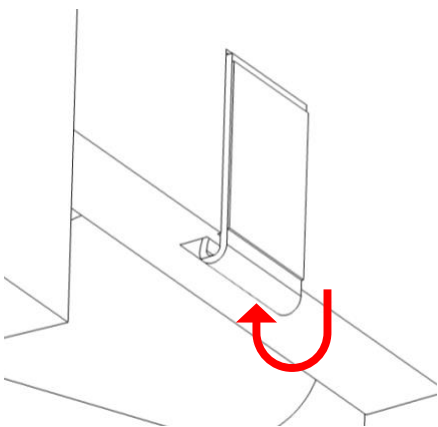
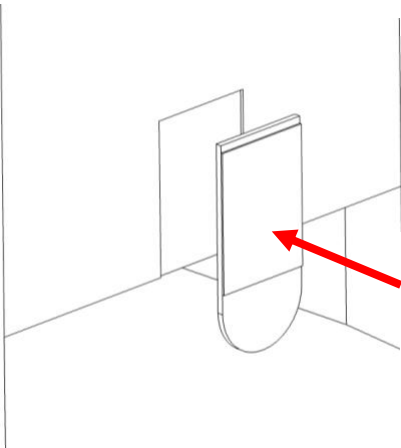
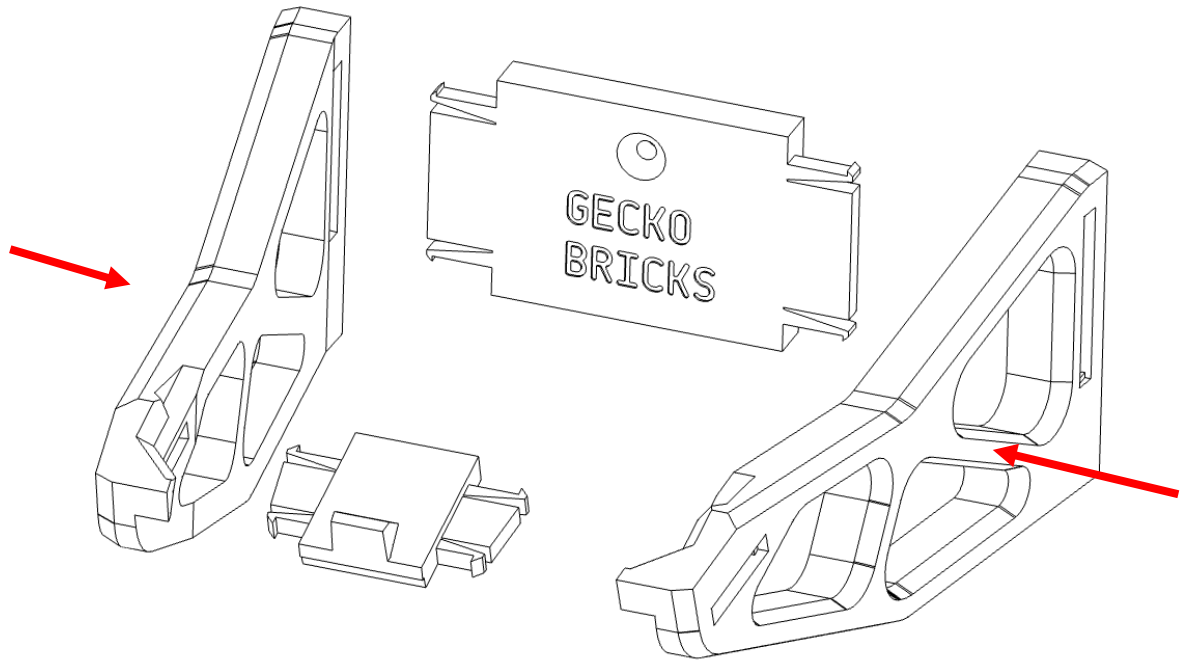
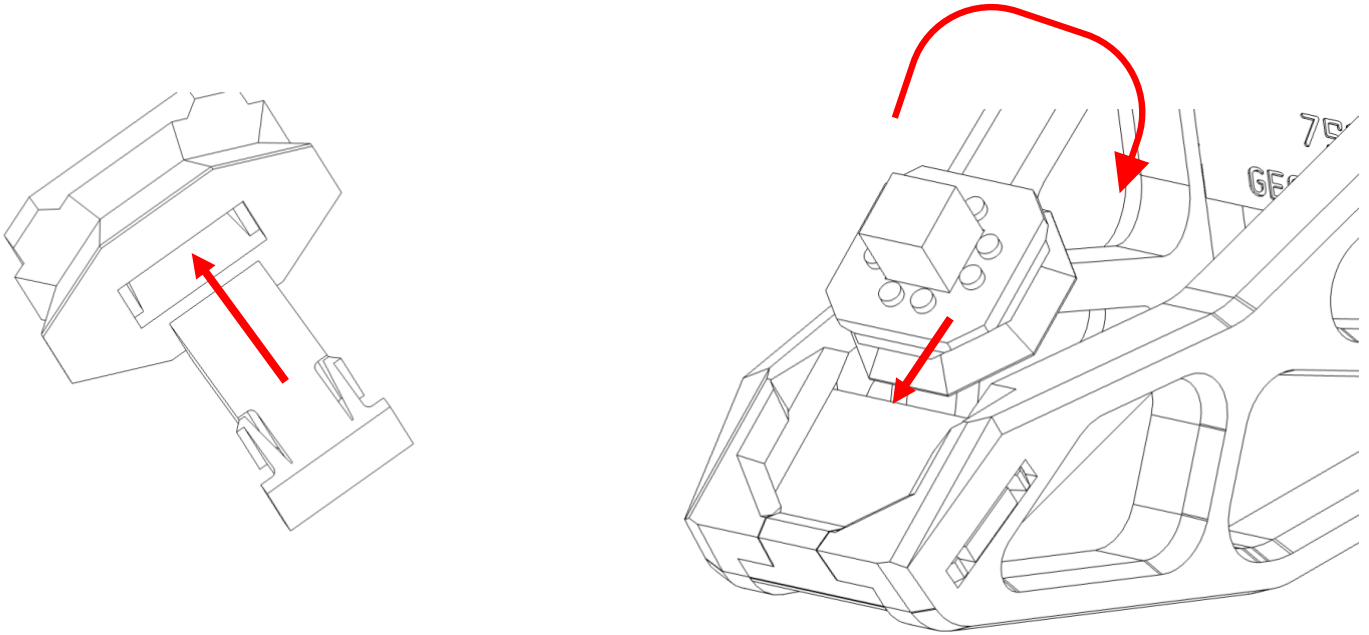

Mount the adaptor piece under the set at the centre of balance.

This adaptor can be inserted at a 45 degree rotation either left or right to orient the A-wing set to your preferred position.

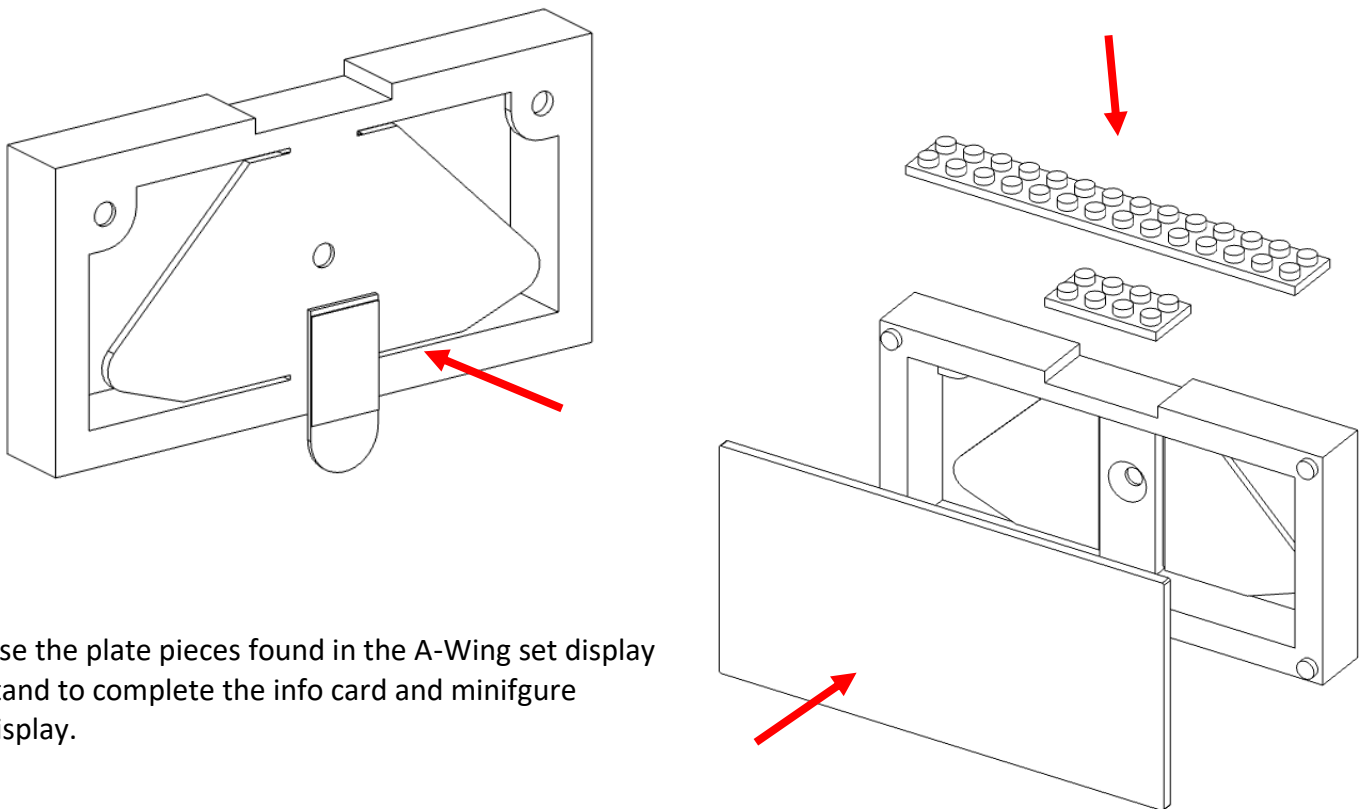

Use the plate pieces found in the A-Wing set display stand to complete the info card and minifigure display.

## Wall mount Instructions For UCS A-Wing – (75275)

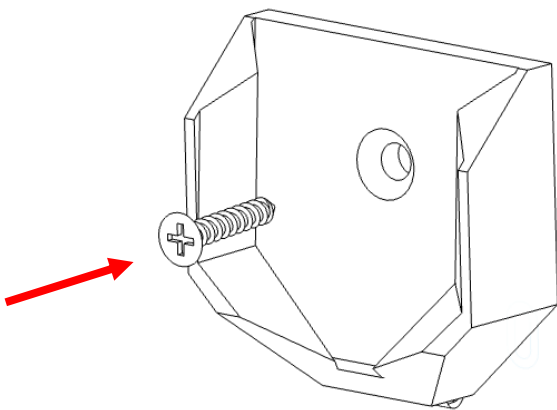
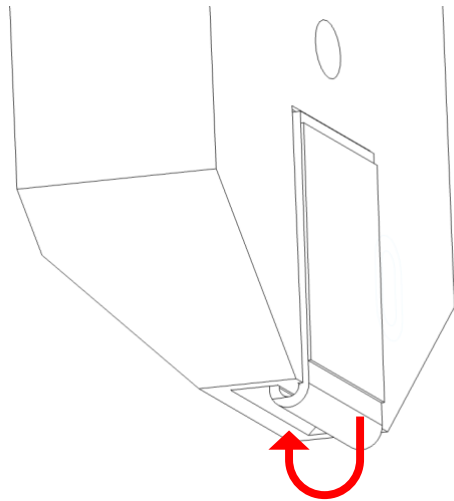
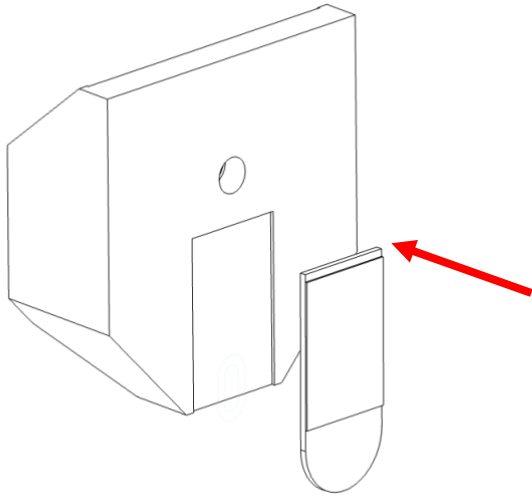

Adaptor piece can be rotated 45 degrees and slide into place in 8 directions.

